

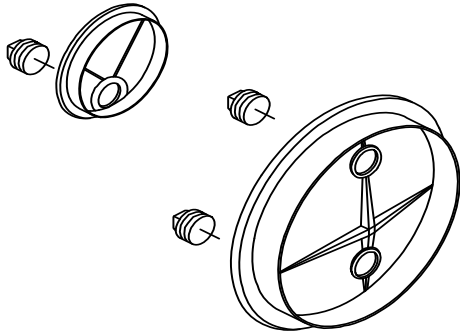

# 1410 & 1510 COUPLING END CAPS

## PRICE INFORMATION



### Standard Sizes:

4" to 12" Nominal Pipe OD

### USE:

Robar 1410 & 1510 End Caps are used in conjunction with a standard ROBAR coupling (ordered separately) for the purpose of:  
Temporary stops for mains to be extended in future

### MATERIAL SPECIFICATION

CAP: Cast Ductile Iron (ASTM A536)  
PLUG: Cast Iron - 2"IP square head  
COATING: 1410 - two coats of Enamel  
1510 - Corrosion Protective Epoxy Coated (AWWA C-213). NSF 61 Approved

For an enamel coated 8" End Cap, the ordering code is:  
1410 - 8" c/w 1 1"IP outlet

| Nominal Pipe Size | Cap OD | Outlet Plug Quantity | PRICE     |           |
|-------------------|--------|----------------------|-----------|-----------|
|                   |        |                      | 1410      | 1510      |
| 4                 | 5.1    | 1                    | \$ 51.47  | \$ 63.86  |
| 6                 | 7.1    | 1                    | \$ 57.62  | \$ 70.66  |
| 8                 | 9.3    | 1                    | \$ 77.15  | \$ 93.20  |
| 10                | 11.4   | 2                    | \$ 115.50 | \$ 139.22 |
| 12                | 13.6   | 2                    | \$ 148.44 | \$ 177.08 |

Note: End capped coupling must be restrained to resist hydraulic end thrust

### ROBAR INDUSTRIES LTD.

BC Phone (604) 591-8811 / 1-800-663-6553  
Fax (604) 591-5288  
Email: waterworks@robarindustries.com  
Web: www.robarindustries.com

### LES PRODUITS INDUSTRIELS ROBAR INC.

QUEBEC Phone (450) 641-9525 / 1-800-315-9525  
Fax (450) 641-4894