



# 9010 DRILLING MACHINE



NEW MODEL - NO EXTENSION REQUIRED:

The **9010** Drill Master is the result of 30 years of revisions to the original Dan-Dee drilling machine. It is made of the finest non-corrosive materials, with each machine being individually inspected prior to shipment. Its light weight, versatility, and ease of operation have made it a favorite of installers within the Waterworks Industry.

FOR DRILLING DI, CI, A/C, STEEL AND PLASTIC MAINS.

TYPE **9010**:

- A compact tool that drills mains for 3/4", 1", 1-1/4", 1-1/2" and 2" CC or IP Taps. (See manufacturer's notes.)
- Completes the operation before you can set up older, heavier machinery.
- Removes the coupon from the pipe - No drillings in your water system.
- For tapping (Hot & Dry) DI, CI, A/C, Steel and Plastic mains.
- Basic machine includes: ratchet wrench, pilot drill, allen wrench and carrying case. (See page 9.1.2)
- Machine weight: 7 lbs. Shipping weight w/carrying case: 17 lbs.

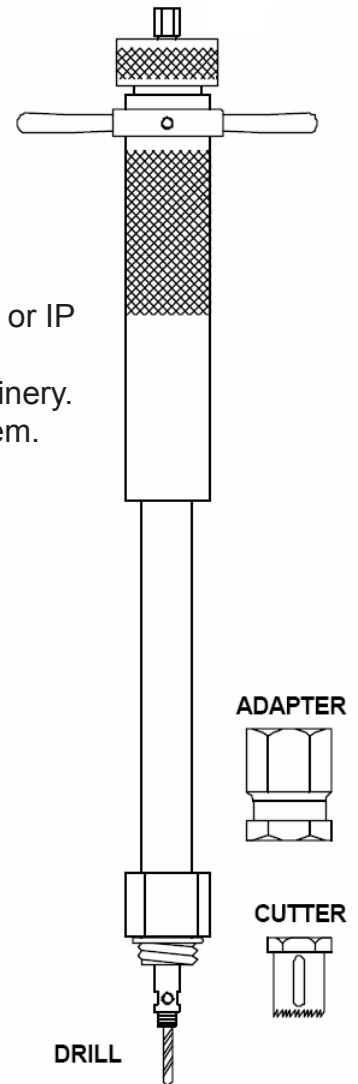

- Note:
- The **9010** is not recommended for use on any fluid distribution system other than water.
  - The use of mechanical assist tools such as drill motors or impact hammers is not recommended, as such use may bind the cutter and possibly break the stainless steel shaft.
  - Avoid the drilling of pipes with pressures in excess of 175 PSI, as higher pressures may blow out seals.
  - Observe all accepted safety precautions when operating machine.

**ROBAR INDUSTRIES LTD. - BRITISH COLUMBIA**

Phone: (604) 591 - 8811  
Toll Free: (800) 663 - 6553  
Fax: (604) 591 - 5288

**LES PRODUITS INDUSTRIELS ROBAR INC. - QUEBEC**

Phone: (450) 641 - 9525  
Toll Free: (800) 315 - 9525  
Fax: (450) 641 - 4894

Website: [www.robarindustries.com](http://www.robarindustries.com) / E-mail: [waterworks@robarindustries.com](mailto:waterworks@robarindustries.com)



# APAC 9010

## DRILLING MACHINE

| PART NUMBER | DESCRIPTION   |
|-------------|---|
| 9010        | Drilling Machine - Manual operation c/w Carrying Case   |
| 902-048     | 1 1/2" Adapter for corp. stops with compression outlets |
| 902-049     | 2" Adapter for corp. stops with compression outlets     |
| 902-050     | 3/4" Adapter for corp. stops with compression outlets   |
| 902-051     | 3/4" IP Adapter   |
| 902-052     | 1" Adapter for corp. stops with compression outlets     |
| 902-053     | 1" IP Adapter   |
| 902-054     | 1 1/4" Adapter for corp. stops with compression outlets |
| 902-055     | 1 1/4" IP Adapter                                       |
| 902-056     | 1 1/2" Copper Adapter *Not common                       |
| 902-057     | 1 1/2" IP Adapter                                       |
| 902-058     | 2" Copper Adapter *Not common                           |
| 902-059     | 2" IP Adapter   |
| 903-071     | 11/16" Hole Saw (for 3/4" high speed)                   |
| 903-072     | 7/8" Hole Saw (for 1" high speed)                       |
| 903-073     | 1 1/8" Hole Saw (for 1 1/4" high speed)                 |
| 903-074     | 1 3/8" Hole Saw (for 1 1/2" high speed)                 |
| 903-075     | 1 7/8" Hole Saw (for 2" high speed)                     |
| 905-040     | 11/16" Hole Saw (for 3/4" Carbide tipped)               |
| 905-041     | 7/8" Hole Saw (for 1" Carbide tipped)                   |
| 905-042     | 1 1/8" Hole Saw (for 1 1/4" Carbide tipped)             |
| 905-043     | 1 3/8" Hole Saw (for 1 1/2" Carbide tipped)             |
| 905-044     | 1 7/8" Hole Saw (for 2" Carbide tipped)                 |
| A           | 908-080 Ratchet Wrench                                  |
| B           | 908-081 Shaft Drive Nut                                 |
| C           | 908-082 Brass Bearing Cap                               |
| D           | 908-083 Feed Hand Wheel                                 |
| E           | 908-084 Feed Wheel Set Screw                            |
| F           | 908-085 Thrust Bearing                                  |
| G           | 908-086 Brass Feed Tube                                 |
| H           | 908-087 Teflon Wiper                                    |
| I           | 908-088 Metal Snap Ring                                 |
| J           | 908-089 Brass Body                                      |
| K           | 908-090 O-Ring Packing                                  |
| L           | 908-091 Gasket (machine to adapter)                     |
| M           | 908-092 SS Shaft  |
| N           | 908-093 Shaft Snap Ring                                 |
| O           | 908-094 Pilot Drill                                     |
| P           | 908-095 Set Screw                                       |
| Q           | 908-096 Allen Wrench                                    |
|             | 908-097 Shell Cutter Bushing                            |

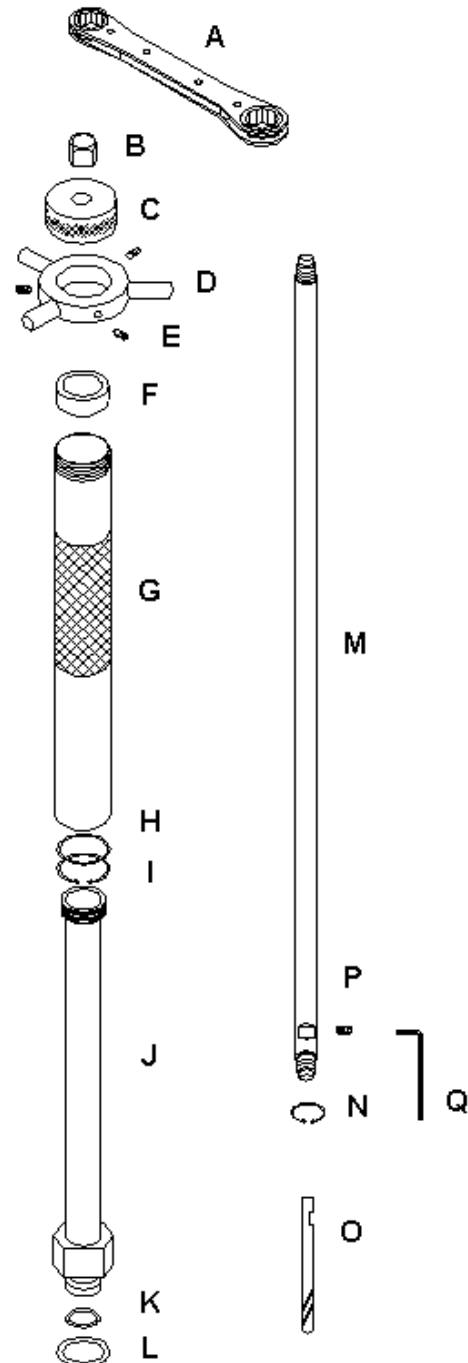

Note: - Shell Cutter Bushing is required for using 1-1/2" and 2" Hole Saw Cutters.

**ROBAR INDUSTRIES LTD. - BRITISH COLUMBIA**

Phone: (604) 591 - 8811  
Toll Free: (800) 663 - 6553  
Fax: (604) 591 - 5288

**LES PRODUITS INDUSTRIELS ROBAR INC. - QUEBEC**

Phone: (450) 641 - 9525  
Toll Free: (800) 315 - 9525  
Fax: (450) 641 - 4894

Website: [www.robarindustries.com](http://www.robarindustries.com) / E-mail: [waterworks@robarindustries.com](mailto:waterworks@robarindustries.com)